

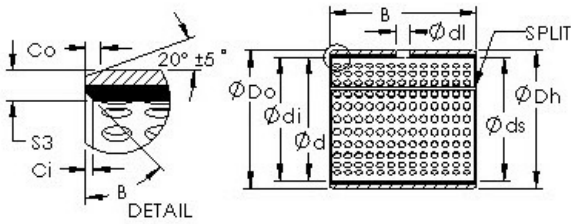

AST AST20 7050 plain bearings



Bearing No. AST20 7050

Bore Diameter	70 mm
Outer Diameter	75 mm
Bearing Type	straight
Shaft Dia., Nominal (d)	70.0000
Shaft Size (ds) - 70 +0 / -0.046	70 +0 / 0.046
Housing Bore Dia. (Dh) - 75 +0.030 / -0	75 +0.030 / 0
Bearing Outside Diameter, Nominal(Do)	75.000
Bearing Outside Diameter Tolerance (Do tol.)	75.100 / 75.055
Bearing Bore after Mounting (di)	70.200 / 70.080
Average Clearance (Cd)	0.1630
Wall Thickness (S3)	2.438
Bearing Length, Nominal (B)	50.000
Bearing Length Tolerance (B tol.) - +0 / -0.40	+0 / 0.40
OD Chamfer Length (Co)	1.800
ID Chamfer Angle (B deg.)	45
ID Chamfer Length (Ci)	0.800
Lube Hole Dia. (dl)	8.000
Material	Carbon steel shell with POM plastic liner

AST20 7050 Bearing 2D drawings and 3D CAD models